

QFN Package; 5x5-32 Lead

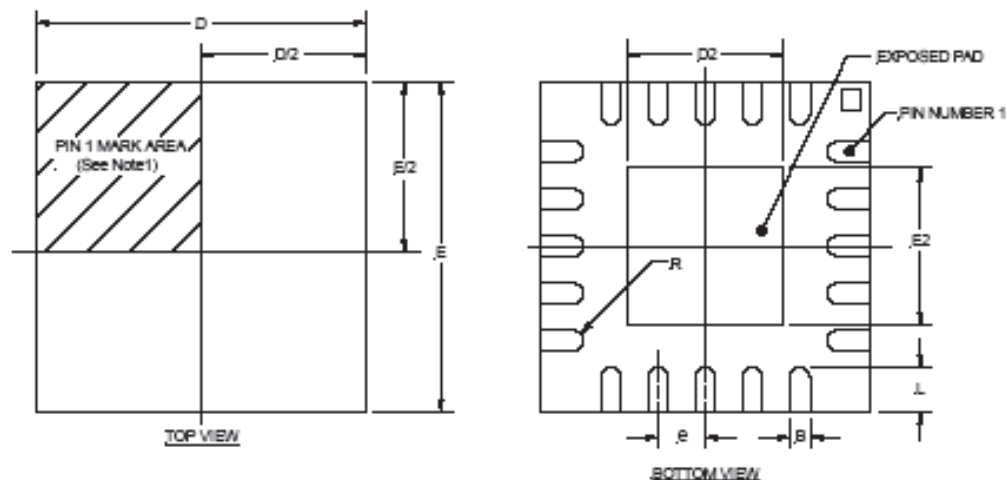

Note 1: Details of pin #1 are optional, but must be located within the zone indicated. The identifier may be molded, or marked features.

SYMBOL	32-PIN 5x5			
	DESIG	MIN	NOM	MAX
A		0.80	0.90	1.00
A1		0.00	0.02	0.05
A3		0.20 REF		
B		0.18	0.23	0.30
D		5.00 BSC		
D2		3.30	3.45	3.55
E		5.00 BSC		
E2		3.30	3.45	3.55
e		0.50 BSC		
L		0.30	0.40	0.50
R		0.09	---	---

NOTE: ALL MEASUREMENTS ARE IN MILLIMETERS.