



Please note that Cypress is an Infineon Technologies Company.

The document following this cover page is marked as “Cypress” document as this is the company that originally developed the product. Please note that Infineon will continue to offer the product to new and existing customers as part of the Infineon product portfolio.

Continuity of document content

The fact that Infineon offers the following product as part of the Infineon product portfolio does not lead to any changes to this document. Future revisions will occur when appropriate, and any changes will be set out on the document history page.

Continuity of ordering part numbers

Infineon continues to support existing part numbers. Please continue to use the ordering part numbers listed in the datasheet for ordering.

NOTE:

1. ALL PARTS TO MEET THE REQUIREMENTS OF CYPRESS SPECIFICATION #03-00029
2. MATERIAL: REFER TO SPEC. #03-00029
3. FINISH: REFER TO SPEC. #03-00029
4. MAX. BURR ON INNER SIDE OF TUBE SHALL BE 0.010 IN.
5. CYPRESS LOGO AND "CYPRESS SEMICONDUCTOR" PRINT ON TUBE IS OPTIONAL
6. TUBE PART NUMBER WITH SLOT: SNCTBI-R, SNCTBI-BL
7. ALL TUBE TOLERANCES TO BE ±0.010 UNLESS OTHERWISE SPECIFIED
8. ALL PLUG TOLERANCES TO BE ±0.015 UNLESS OTHERWISE SPECIFIED

REVISIONS						
PAGE	ZONE	REV	ECN	DESCRIPTION	DATE	APPROVER
1	-	**	112200	NEW RELEASE	12/06/01	
1	-	*A	113286	CHANGE PART # TO SNCTBI-XX / ADD TUBE TYPE / PART # TABLE	02/04/02	
1	-	*B	132817	REMOVED HOLE ON TUBE AND CHANGED TITLE FROM SNC 300 SHIPPING TUBE - CSPI TO SNC 300 SHIPPING TUBE. CHANGED SNCTB PRINT TO SNCTBI	01/15/04	
1	-	*C	234510	ADD SLOTTED TUBE DRAWING, ADD NOTE #6, INSERT RED* SLOTTED TUBE* AND BLACK* SLOTTED TUBE* IN THE TABLE	04/06/04	
1	-	*D	522947	ADD SLOTTED TUBE DRAWING ON END SIDE A	10/19/06	
1	-	*E	986780	ADDED END PLUG DRAWING	04/18/07	
1	-	*F	3260353	UPDATED DRAWING CHANGE DRAWING TEMPLATE	05/27/11	
1	-	*G	4596543	UPDATED DRAWING TEMPLATE	12/15/14	

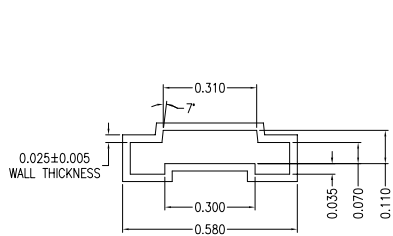

RIGHT SIDE VIEW (WITHOUT SLOT)

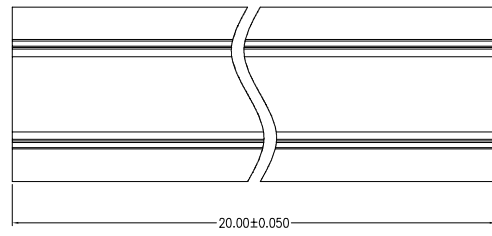

TOP VIEW (WITHOUT SLOT)

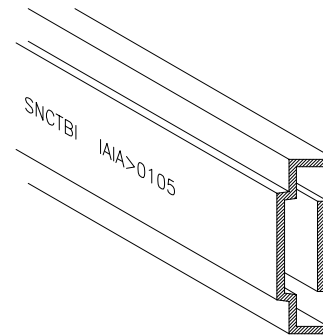

PERSPECTIVE (WITHOUT SLOT)

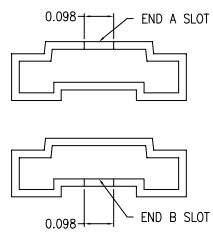
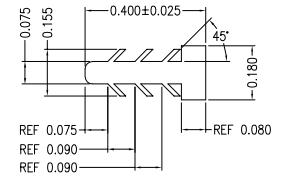

RED/BLACK SLOTTED RIGHT SIDE VIEW

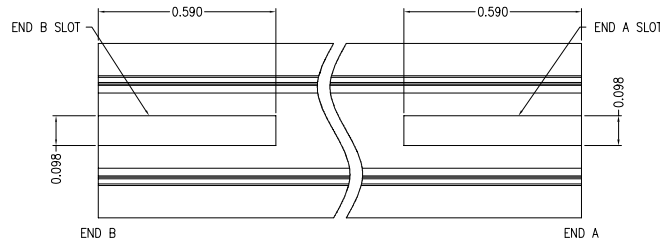

RED/BLACK SLOTTED TOP VIEW

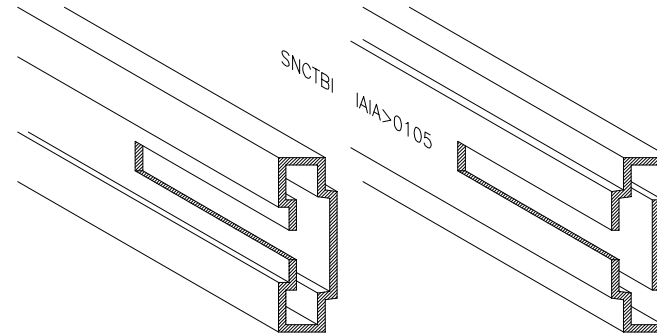

RED/BLACK SLOTTED PERSPECTIVE

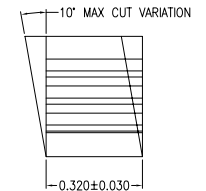

TUBE TYPE	CY PART #
CLEAR WITH BLUE PRINT	SNCTBI-CB
CLEAR WITH GREEN PRINT	SNCTBI-CG
GREEN WITH BLUE PRINT	SNCTBI-G
YELLOW WITH BLUE PRINT	SNCTBI-Y
RED SLOTTED TUBE WITH BLUE PRINT	SNCTBI-R
BLUE WITH BLUE PRINT	SNCTBI-B
BLACK SLOTTED TUBE WITH BLUE PRINT	SNCTBI-BL
ORANGE WITH BLUE PRINT	SNCTBI-O

UNLESS OTHERWISE SPECIFIED		DESIGNED BY	DATE	
ALL DIMENSIONS ARE IN MILLIMETERS STANDARD TOLERANCES ON: DECIMALS ± 0.25 .XX ± 0.25 .XXX ± 0.130 .XXXX ± 0.1300 ANGLES ± 0.5		DRAWN XVC	DATE 12/15/14	
		CHK BY ECVI	DATE 12/15/14	
		APPROVED BY QAD	DATE 12/15/14	
		APPROVED BY UYO	DATE 12/15/14	
MATERIAL SEE NOTE				TITLE SNC 300 SHIPPING TUBE
FINISH SEE NOTE				SIZE A
				PART NO. SNCTBI-XX
				DWG NO 51-51133
				REV *G
DO NOT SCALE				SHEET 1 OF 1