

Pin 1 up to pin 16 omitted for clarity

Bottom view

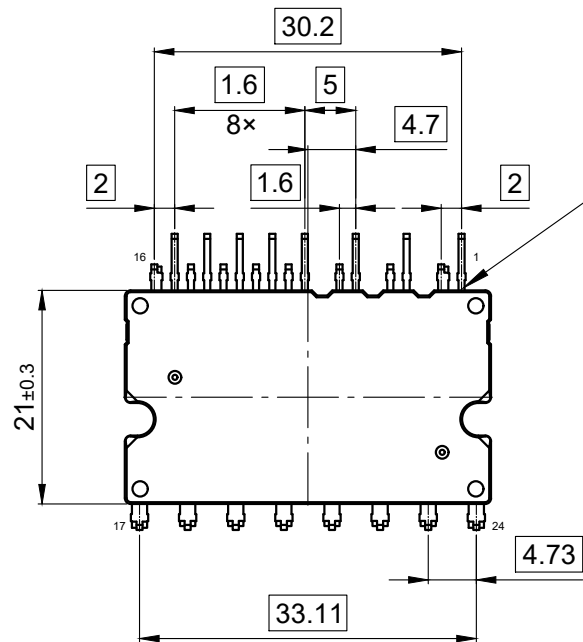

Pin 1 corner side

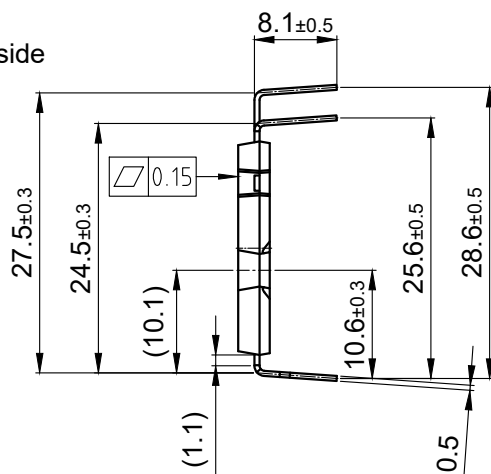

Punched-mold along this equator side
Mold flash along side of leads

0.12 Max. per side

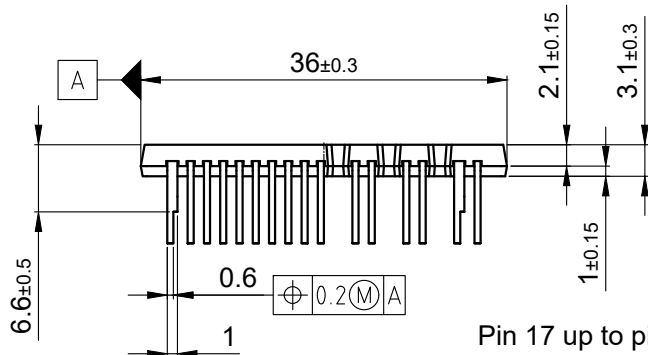
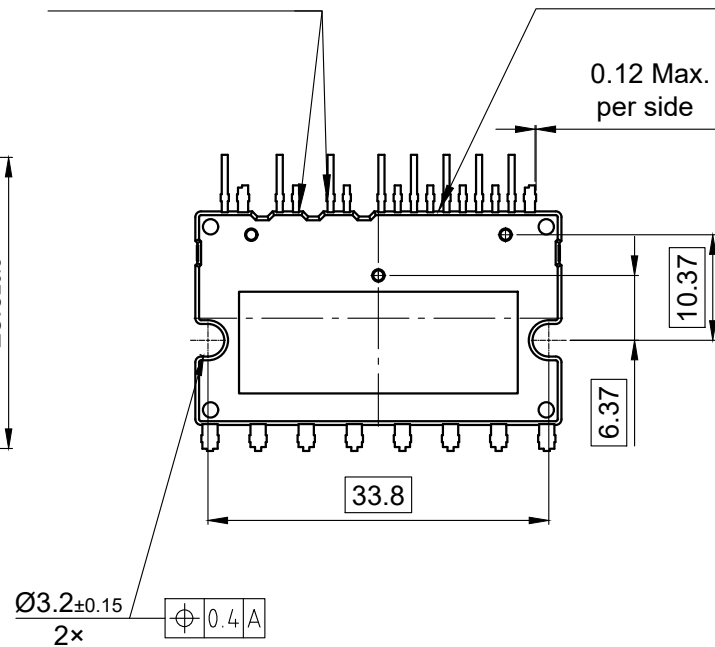

Pin 17 up to pin 24 omitted for clarity

All dimensions are in units mm

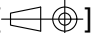
The drawing is in compliance with ISO 128-30, Projection Method 1 []

Drawing according to ISO 8015, general tolerances $\pm 0.1/\pm 1^\circ$