

**Please note that Cypress is an Infineon Technologies Company.**

The document following this cover page is marked as “Cypress” document as this is the company that originally developed the product. Please note that Infineon will continue to offer the product to new and existing customers as part of the Infineon product portfolio.

**Continuity of document content**

The fact that Infineon offers the following product as part of the Infineon product portfolio does not lead to any changes to this document. Future revisions will occur when appropriate, and any changes will be set out on the document history page.

**Continuity of ordering part numbers**

Infineon continues to support existing part numbers. Please continue to use the ordering part numbers listed in the datasheet for ordering.

REVISIONS						
PAGE	ZONE	REV	ECN	DESCRIPTION	DATE	APPROVED
1	-	**	2564717	CREATED SPEC	09/10/08	MLA
1	-	*A	2820496	CHANGE TEMPLATE, CHANGE TITLE FROM 120LD EXPOSED PAD TQFP (14X14X1.0) PKG. OUTLINE TO PACKAGE OUTLINE, 120L TQFP 14X14X1.0 MM AE120A 6.5X6.5 EPAD	12/03/09	QAD
1	-	*B	3701436	CHANGED PACKAGE WEIGHT INFORMATION FROM 0.6grams TO "REFER TO PMDD SPEC.	08/02/12	QAD

## TOP VIEW

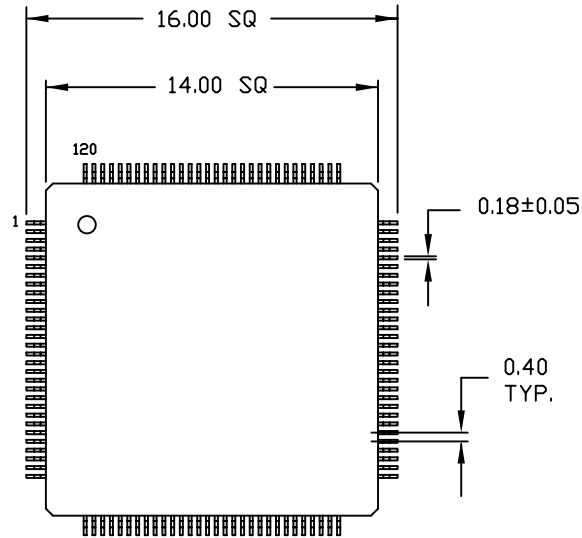

## BOTTOM VIEW

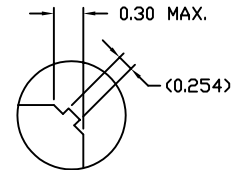
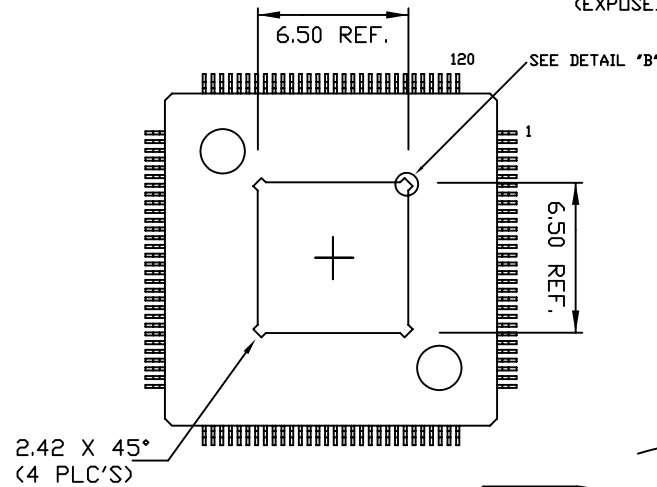

DETAIL "B"  
(EXPOSED PAD CORNER DETAIL)

## SEATING PLANE

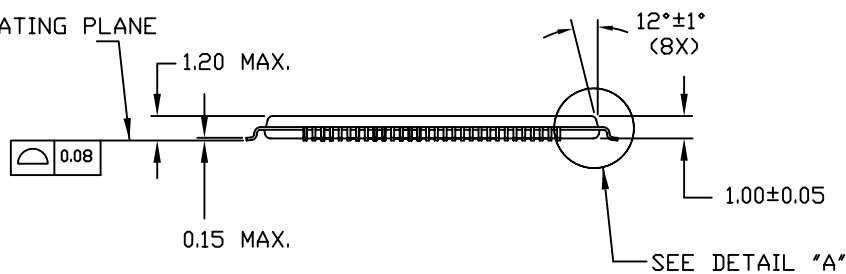

STAND-OFF  
0.05 MIN.  
0.15 MAX.

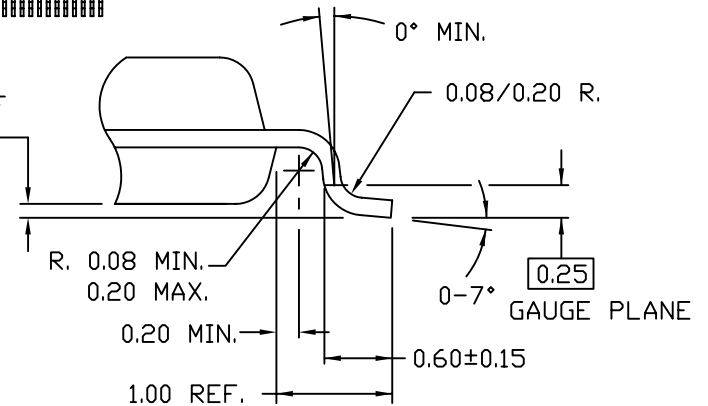

DETAIL "A"

DIMENSIONS IN MILLIMETERS

Refer to Jedec Drawing MS-026

Package Weight - Refer to PMDD spec.

THIS DRAWING CONTAINS INFORMATION WHICH IS THE PROPRIETARY PROPERTY OF CYPRESS SEMICONDUCTOR CORPORATION. THIS DRAWING IS RECEIVED IN CONFIDENCE AND ITS CONTENTS MAY NOT BE DISCLOSED WITHOUT WRITTEN CONSENT OF CYPRESS SEMICONDUCTOR CORPORATION.

UNLESS OTHERWISE SPECIFIED ALL DIMENSIONS ARE IN MILLIMETERS STANDARD TOLERANCES ARE:		DESIGNED BY	N/A	DATE	N/A
DECIMALS		DRAWN BY	MLA	DATE	09/10/08
.XX ± 0.05	ANGLES	CHECKED BY	TSV	DATE	12/03/09
.XXX ±	± 1°	APPROVED BY	QAD	DATE	12/03/09
.XXXX +		APPROVED BY	JGUA	DATE	12/03/09
MATERIAL	N/A	APPROVED BY		DATE	
FINISH	N/A				
		CYPRESS Company Confidential		TITLE PACKAGE OUTLINE, 120L TQFP 14X14X1.0 MM AE120A 6.5X6.5 EPAD	
SIZE	A	PART NO.	AE120A	DWG NO.	001-48723
REV	*B	SCALED TO FIT	N/A	SHEET	1 OF 1