

The technical drawing shows two views of the connector:

- Side View (Top):** Shows the profile of the connector. Key dimensions include:
 - Total height: 20.5 ± 0.5
 - Height from base to mounting holes: 17 ± 0.35
 - Mounting hole diameter: $\varnothing 4$
 - Distance between mounting holes: 12
 - Pin pitch: 14
 - Pin length: 8.15 ± 0.35
 - Pin diameter: 0.5
 - A callout 'X' points to the contact area.
- Top View (Bottom):** Shows the footprint of the connector. Key dimensions include:
 - Overall width: 55.9
 - Width between mounting holes: 40.6
 - Mounting hole diameter: 12
 - Overall height: 45.6
 - Height between mounting holes: 39.6
 - Mounting hole offset from edge: 23
 - Edge distance to pin center: 26.6
 - Pin pitch: 2
 - Pin diameter: $\varnothing 0.8$

Technical drawing of a rectangular plate with the following dimensions and features:

- Overall width: 50.58
- Overall height: 28.68
- Left side hole diameter: $\varnothing 3.2$
- Right side hole diameter: $\varnothing 3.2$
- Top edge hole diameter: $\varnothing 3.2$
- Bottom edge hole diameter: $\varnothing 3.2$
- Distance from left edge to first hole: 2.32
- Distance from top edge to first hole: 3.08
- Distance from first hole to second hole: 24.13
- Distance from second hole to right edge: 9.68
- Distance from bottom edge to first hole: 15.88
- Distance from bottom edge to second hole: 22.08

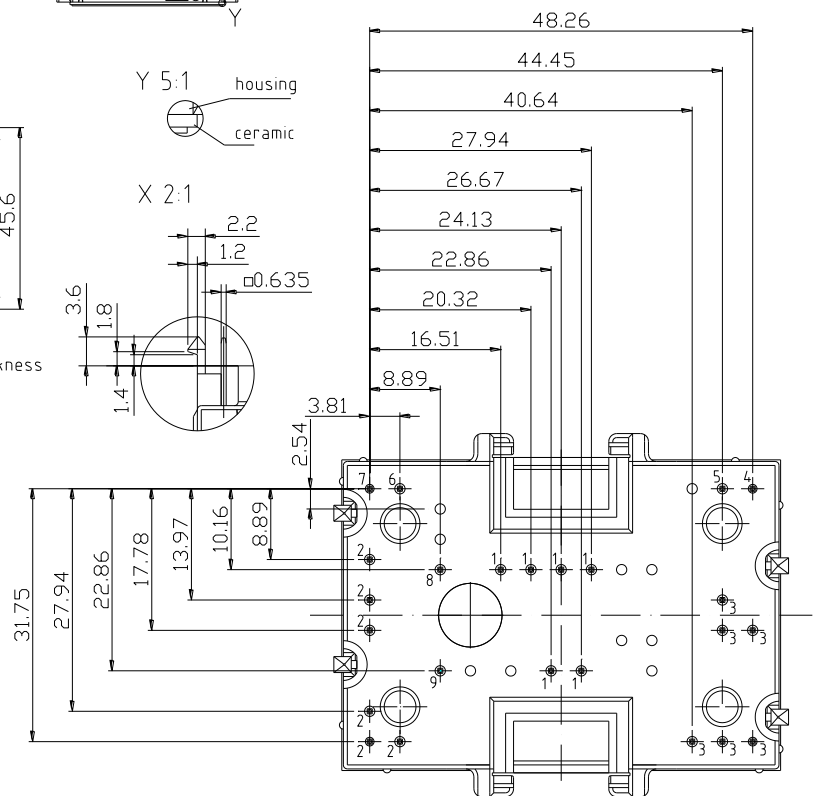
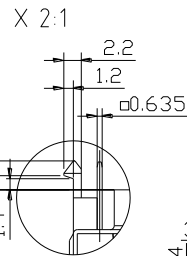
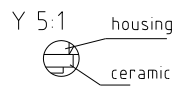
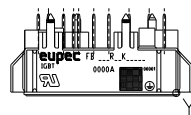

	$\phi 0.4$
---	------------

Circuit diagram FF100R12YT3

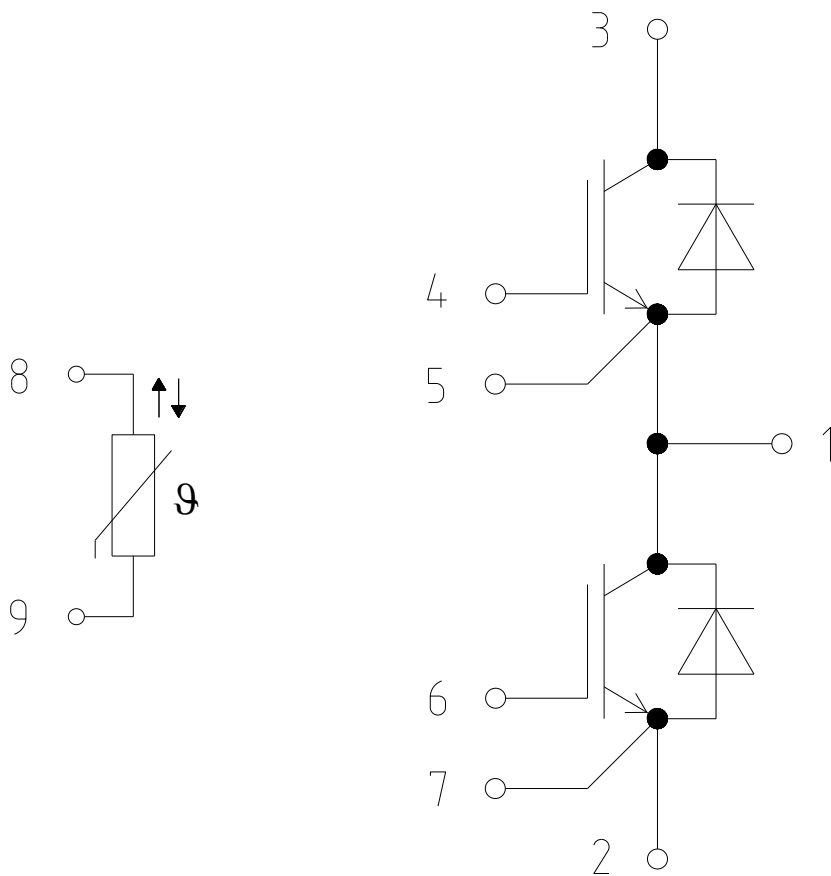

Edition 2017-03-02

Published by

Infineon Technologies AG
81726 München, Germany

© 2017 Infineon Technologies AG.
All Rights Reserved.

Do you have a question about this document?

Email: erratum@infineon.com

Document reference

ifx

IMPORTANT NOTICE

The information given in this document shall in no event be regarded as a guarantee of conditions or characteristics ("Beschaffenhheitsgarantie").

With respect to any examples, hints or any typical values stated herein and/or any information regarding the application of the product, Infineon Technologies hereby disclaims any and all warranties and liabilities of any kind, including without limitation warranties of non-infringement of intellectual property rights of any third party.

In addition, any information given in this document is subject to customer's compliance with its obligations stated in this document and any applicable legal requirements, norms and standards concerning customer's products and any use of the product of Infineon Technologies in customer's applications.

The data contained in this document is exclusively intended for technically trained staff. It is the responsibility of customer's technical departments to evaluate the suitability of the product for the intended application and the completeness of the product information given in this document with respect to such application.

For further information on the product, technology, delivery terms and conditions and prices please contact your nearest Infineon Technologies office (www.infineon.com).

WARNINGS

Due to technical requirements products may contain dangerous substances. For information on the types in question please contact your nearest Infineon Technologies office.

Except as otherwise explicitly approved by Infineon Technologies in a written document signed by authorized representatives of Infineon Technologies, Infineon Technologies' products may not be used in any applications where a failure of the product or any consequences of the use thereof can reasonably be expected to result in personal injury.