

| REV. | DESCRIPTION | ECN | DATE |
|------|----------------|------------|---------|
| C | CHANGE PER ECN | 1120_10109 | 10-7-24 |

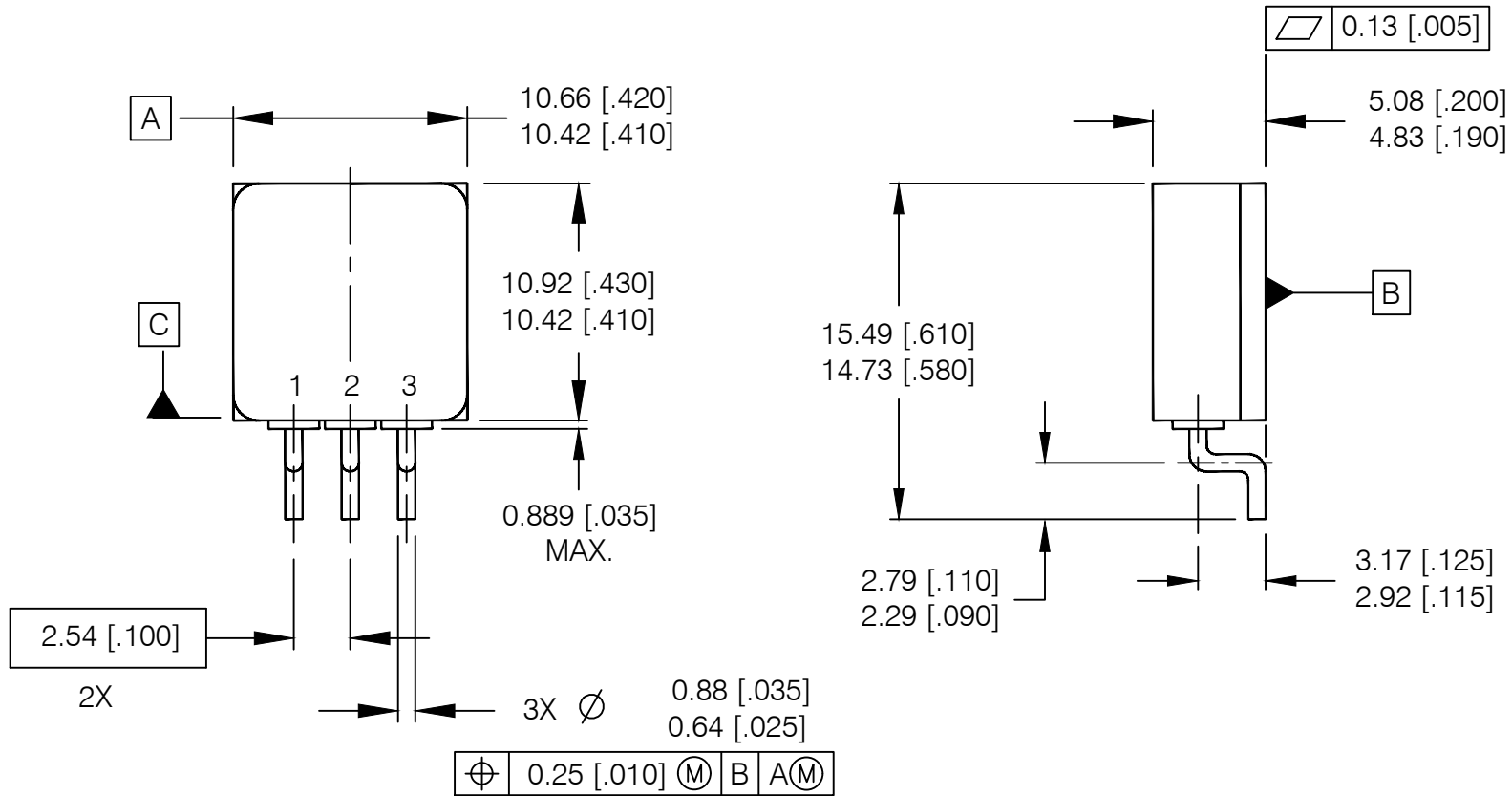

NOTES:

1. DIMENSIONING & TOLERANCING PER ASME Y14.5M-1994.
2. ALL DIMENSIONS ARE SHOWN IN MILLIMETERS [INCHES].
3. THIS OUTLINE IS A MODIFIED TO-257AA JEDEC OUTLINE.
4. STANDARD FINAL FINISH ON ALL TERMINALS IS SOLDER ALLOY 63%Sn 37%Pb.

IOR HiRel
An Infineon Technologies Company

TITLE: PACKAGE OUTLINE: TO-257AA
TABLESS, STD & LOW OHMIC,
SURFACE MOUNT LEADFORM

DRAWING NO.
D100765G-WEB

REV C