

MOSFET

OptiMOS™ 7 Power-Transistor, 25 V

Features

- N-channel, logic level
- Optimized for soft-switching topologies
- Very low on-resistance $R_{DS(on)}$ at $V_{GS}=4.5V$
- Excellent gate charge x $R_{DS(on)}$ product (FOM)
- Superior thermal resistance, dual side cooling feature
- 100% avalanche tested
- Pb-free lead plating; RoHS compliant
- Halogen-free according to IEC61249-2-21

Product validation

Qualified for industrial applications according to the relevant tests of JEDEC JESD47, JESD22 and J-STD-020.

Table 1 Key performance parameters

Parameter	Value	Unit
V_{DS}	25	V
$R_{DS(on),max}$	0.42	mΩ
I_D	460	A
Q_{oss}	52	nC
$Q_G (0V...4.5V)$	29	nC

Part number	Package	Marking	Related links
IQEH42NE2LM7ZCGSC	PG-WHTFN-9	Z	-

PG-WHTFN-9 (3x3)

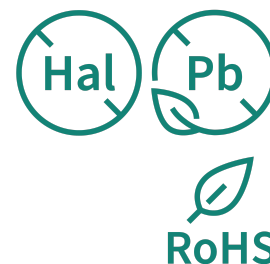
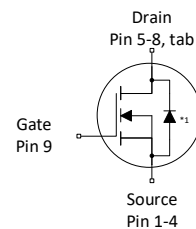
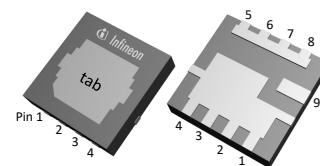



Table of contents

Description	1
Maximum ratings	3
Thermal characteristics	3
Electrical characteristics	4
Electrical characteristics diagrams	6
Package outlines	10
Revision history	13
Trademarks	14
Disclaimer	14

1 Maximum ratings

at $T_A=25\text{ °C}$, unless otherwise specified

Table 2 Maximum ratings

Parameter	Symbol	Values			Unit	Note / Test condition
		Min.	Typ.	Max.		
Continuous drain current ¹⁾	I_D	-	-	460	A	$V_{GS}=10\text{ V}, T_C=25\text{ °C}$
				325		$V_{GS}=10\text{ V}, T_C=100\text{ °C}$
				279		$V_{GS}=4.5\text{ V}, T_C=100\text{ °C}$
				59		$V_{GS}=10\text{ V}, T_A=25\text{ °C}, R_{thJA}=60\text{ °C/W}^2)$
Pulsed drain current ³⁾	$I_{D,pulse}$	-	-	1840	A	$T_C=25\text{ °C}$
Avalanche energy, single pulse ⁴⁾	E_{AS}	-	-	340	mJ	$I_D=20\text{ A}, R_{GS}=25\text{ }\Omega$
Gate source voltage	V_{GS}	-12	-	12	V	-
Power dissipation	P_{tot}	-	-	150	W	$T_C=25\text{ °C}$
				2.5		$T_A=25\text{ °C}, R_{thJA}=60\text{ °C/W}^2)$
Operating and storage temperature	T_j, T_{stg}	-55	-	175	°C	-

¹⁾ Rating refers to the product only with datasheet specified absolute maximum values, maintaining case temperature as specified. For other case temperatures please refer to Diagram 2. De-rating will be required based on the actual environmental conditions.

²⁾ Device on 40 mm x 40 mm x 1.5 mm epoxy PCB FR4 with 6 cm² (one layer, 70 µm thick) copper area for drain connection. PCB is vertical in still air.

³⁾ See Diagram 3 for more detailed information

⁴⁾ See Diagram 13 for more detailed information

2 Thermal characteristics

Table 3 Thermal characteristics

Parameter	Symbol	Values			Unit	Note / Test condition
		Min.	Typ.	Max.		
Thermal resistance, junction - case, bottom	R_{thJC}	-	-	1.0	°C/W	-
Thermal resistance, junction - case, top	R_{thJC}		0.7	-		
Thermal resistance, junction - ambient, 6 cm ² cooling area ⁵⁾	R_{thJA}		-	60		

⁵⁾ Device on 40 mm x 40 mm x 1.5 mm epoxy PCB FR4 with 6 cm² (one layer, 70 µm thick) copper area for drain connection. PCB is vertical in still air.

3 Electrical characteristics

at $T_j=25\text{ °C}$, unless otherwise specified

Table 4 Static characteristics

Parameter	Symbol	Values			Unit	Note / Test condition
		Min.	Typ.	Max.		
Drain-source breakdown voltage	$V_{(BR)DSS}$	25	-	-	V	$V_{GS}=0\text{ V}$, $I_D=1\text{ mA}$
Gate threshold voltage	$V_{GS(th)}$	1.1	1.4	1.7	V	$V_{DS}=V_{GS}$, $I_D=432\text{ }\mu\text{A}$
Zero gate voltage drain current	I_{DSS}	-	0.1	1	μA	$V_{DS}=22\text{ V}$, $V_{GS}=0\text{ V}$, $T_j=25\text{ °C}$
			10	100		$V_{DS}=22\text{ V}$, $V_{GS}=0\text{ V}$, $T_j=125\text{ °C}$
Gate-source leakage current	I_{GSS}	-	10	100	nA	$V_{GS}=12\text{ V}$, $V_{DS}=0\text{ V}$
Drain-source on-state resistance	$R_{DS(on)}$	-	0.36	0.42	m Ω	$V_{GS}=10\text{ V}$, $I_D=20\text{ A}$
			0.47	0.57		$V_{GS}=4.5\text{ V}$, $I_D=20\text{ A}$
Gate resistance	R_G	-	0.5	-	Ω	-
Transconductance	g_{fs}	100	200	-	S	$ V_{DS} \geq 2 I_D R_{DS(on)max}$, $I_D=20\text{ A}$

Table 5 Dynamic characteristics

Parameter	Symbol	Values			Unit	Note / Test condition
		Min.	Typ.	Max.		
Input capacitance	C_{iss}	-	4700	6100	pF	$V_{GS}=0\text{ V}$, $V_{DS}=12\text{ V}$, $f=1\text{ MHz}$
Output capacitance	C_{oss}	-	2300	-		
Reverse transfer capacitance	C_{rss}	-	72	-		
Turn-on delay time	$t_{d(on)}$	-	5.9	-	ns	$V_{DD}=12\text{ V}$, $V_{GS}=10\text{ V}$, $I_D=20\text{ A}$, $R_{G,ext}=3\text{ }\Omega$
Rise time	t_r		2.0			
Turn-off delay time	$t_{d(off)}$		35			
Fall time	t_f		5.2			

Table 6 Gate charge characteristics ⁶⁾

Parameter	Symbol	Values			Unit	Note / Test condition
		Min.	Typ.	Max.		
Gate to source charge	Q_{gs}	-	10.8	-	nC	$V_{DD}=12\text{ V}$, $I_D=20\text{ A}$, $V_{GS}=0\text{ to }4.5\text{ V}$
Gate charge at threshold	$Q_{g(th)}$	-	6.6	-	nC	
Gate to drain charge	Q_{gd}	-	4.3	-	nC	
Switching charge	Q_{sw}	-	8.4	-	nC	
Gate charge total	Q_g	-	29	-	nC	
Gate plateau voltage	$V_{plateau}$	-	2.3	-	V	
Gate charge total	Q_g	-	63	-	nC	$V_{DD}=12\text{ V}$, $I_D=20\text{ A}$, $V_{GS}=0\text{ to }10\text{ V}$
Output charge	Q_{oss}	-	52	-	nC	$V_{DS}=12\text{ V}$, $V_{GS}=0\text{ V}$

⁶⁾ See "Gate charge waveforms" for parameter definition

Table 7 Reverse diode

Parameter	Symbol	Values			Unit	Note / Test condition
		Min.	Typ.	Max.		
Diode continuous forward current	I_S	-	-	139	A	$T_C=25\text{ °C}$
Diode pulse current	$I_{S,pulse}$	-	-	1840		
Diode forward voltage	V_{SD}	-	0.75	1.0	V	$V_{GS}=0\text{ V}$, $I_F=20\text{ A}$, $T_j=25\text{ °C}$
Reverse recovery time	t_{rr}	-	29	-	ns	$V_R=12\text{ V}$, $I_F=20\text{ A}$, $di_F/dt=400\text{ A}/\mu\text{s}$
Reverse recovery charge	Q_{rr}	-	110	-	nC	

4 Electrical characteristics diagrams

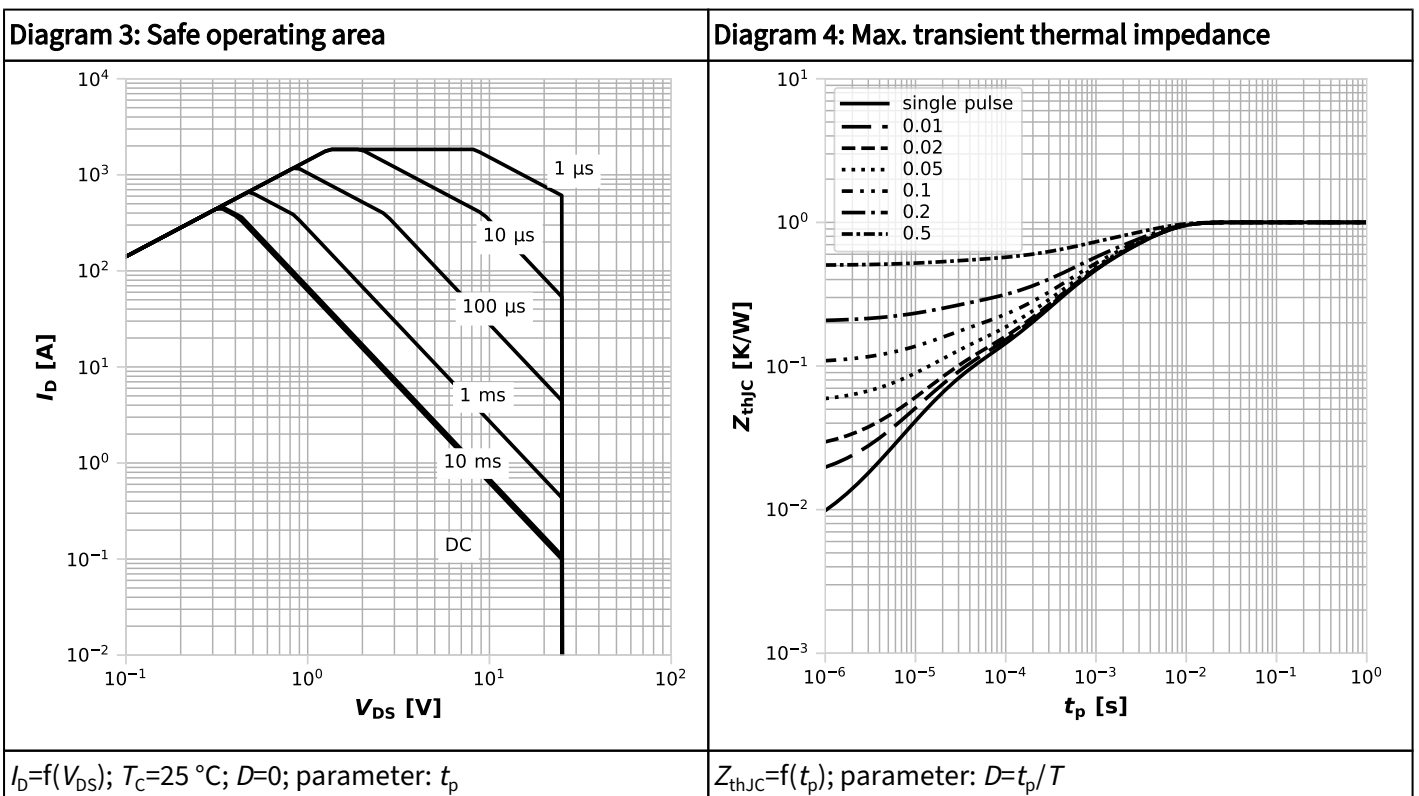
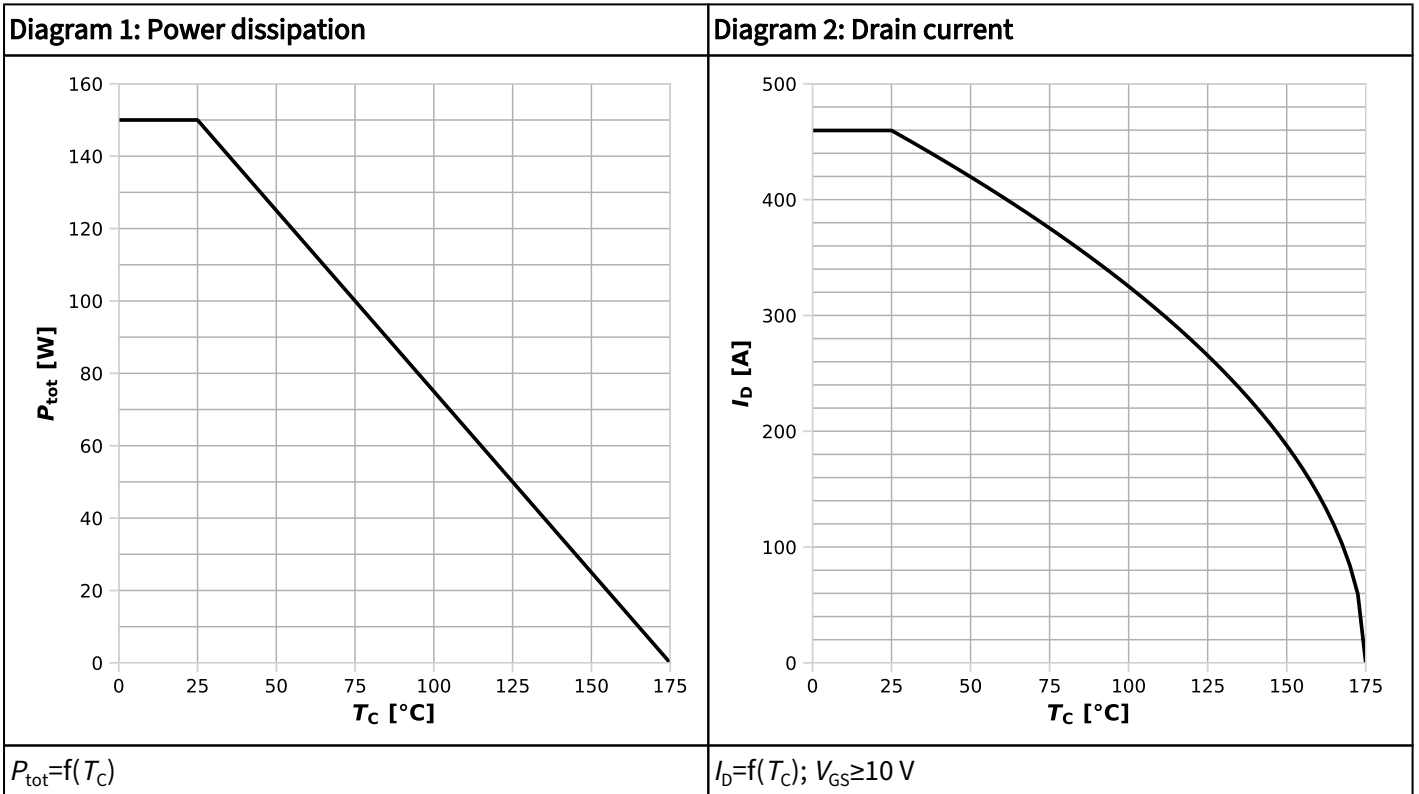
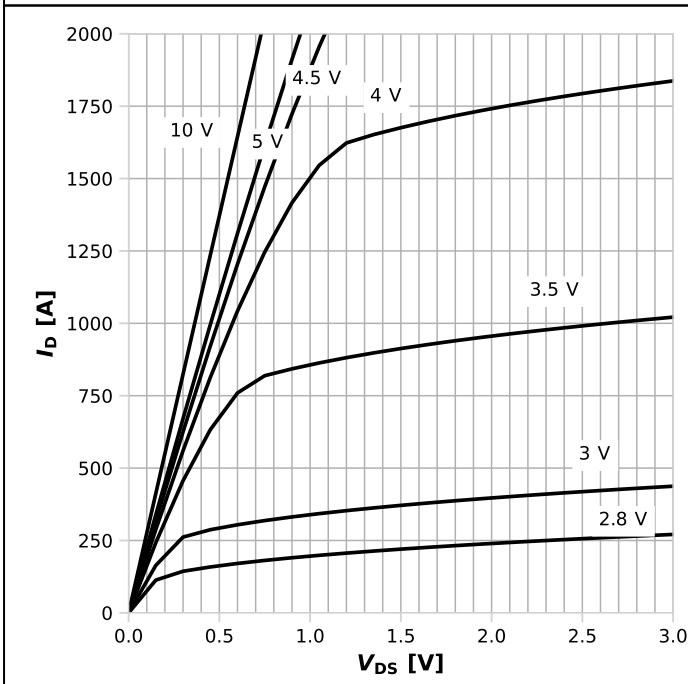
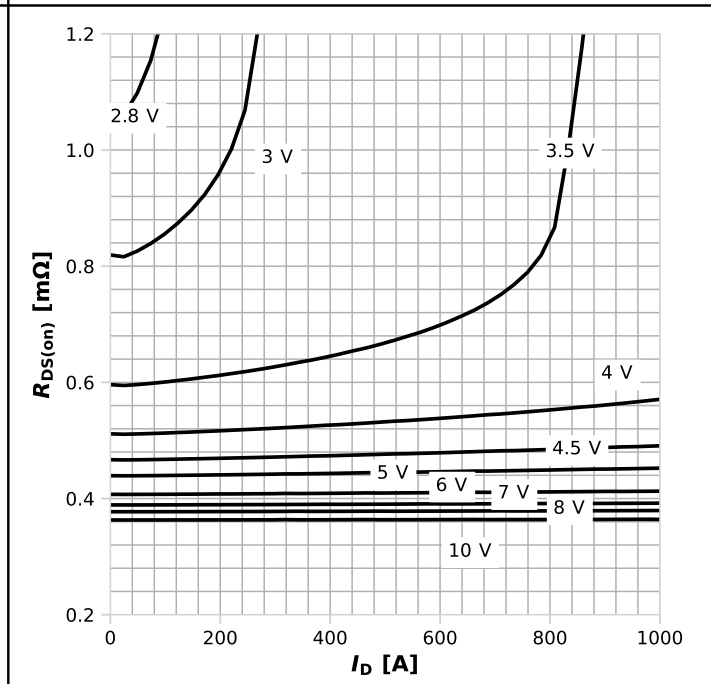

Diagram 5: Typ. output characteristics



$I_D = f(V_{DS}), T_j = 25\text{ °C};$ parameter: V_{GS}

Diagram 6: Typ. drain-source on resistance



$R_{DS(on)} = f(I_D), T_j = 25\text{ °C};$ parameter: V_{GS}

Diagram 7: Typ. transfer characteristics

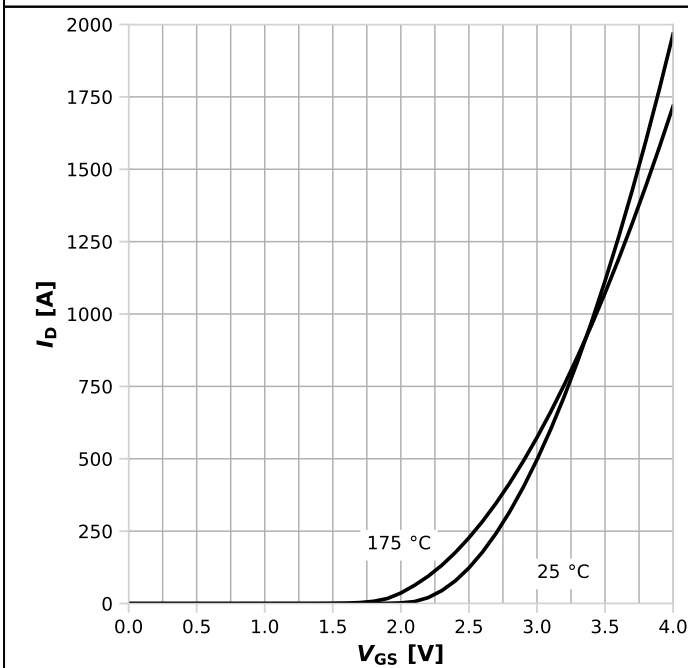

$I_D = f(V_{GS}), |V_{DS}| > 2|I_D|R_{DS(on)max};$ parameter: T_j

Diagram 8: Typ. drain-source on resistance

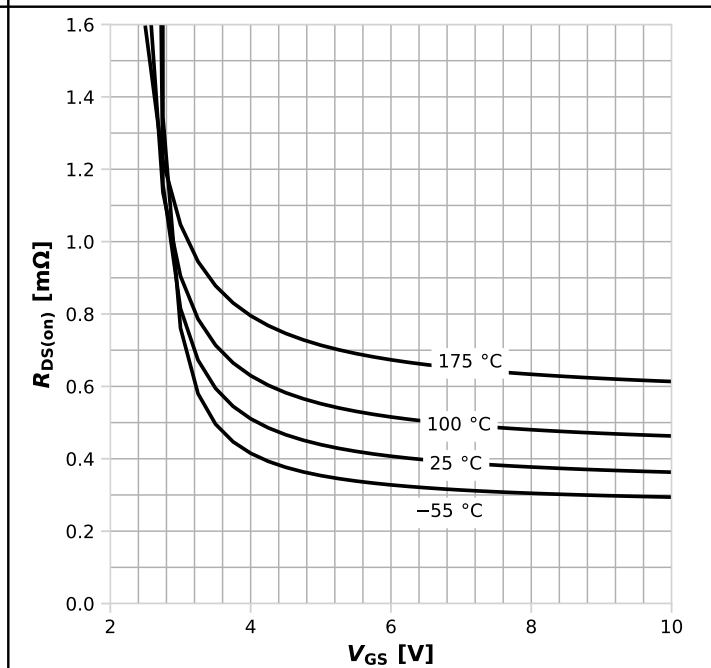

$R_{DS(on)} = f(V_{GS}), I_D = 20\text{ A};$ parameter: T_j

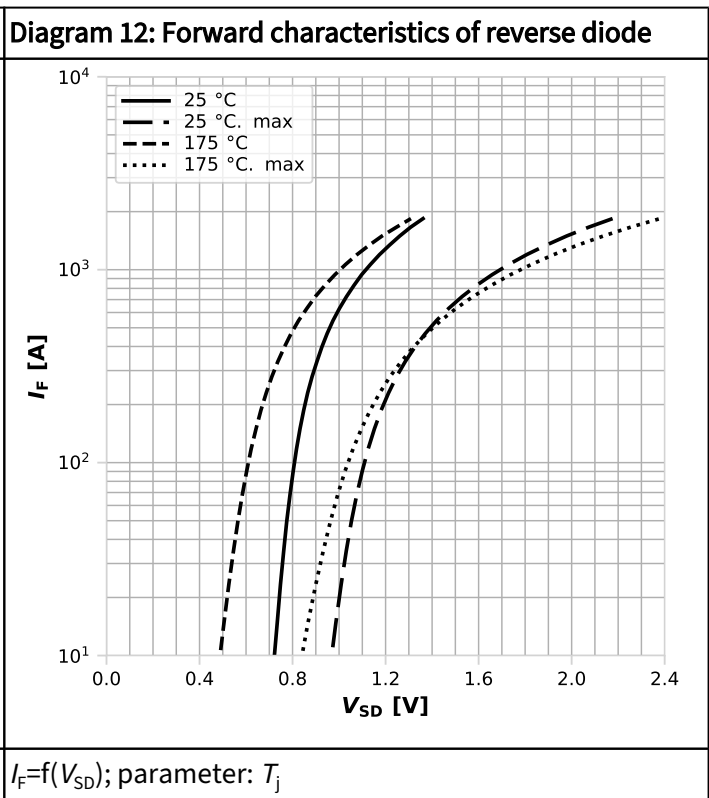
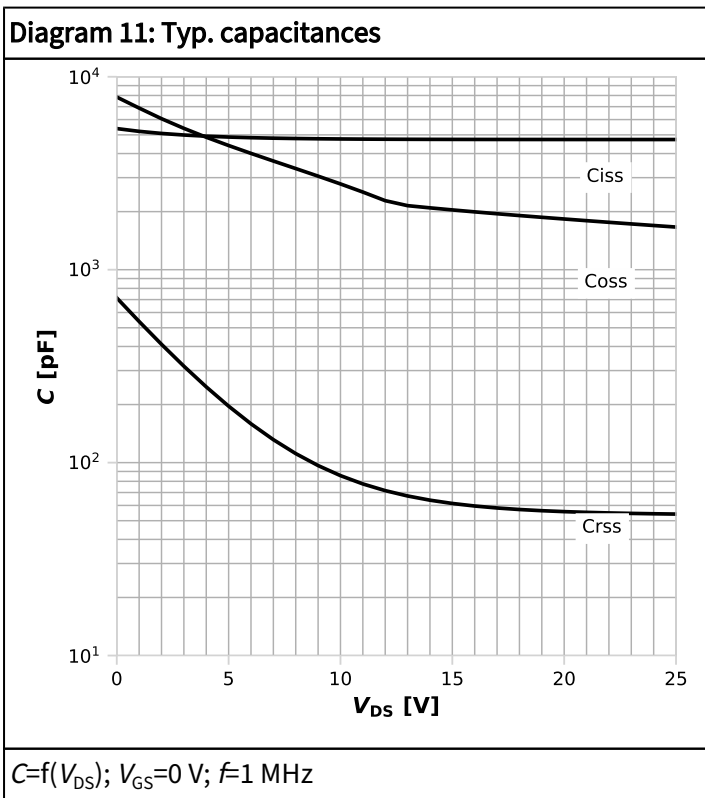
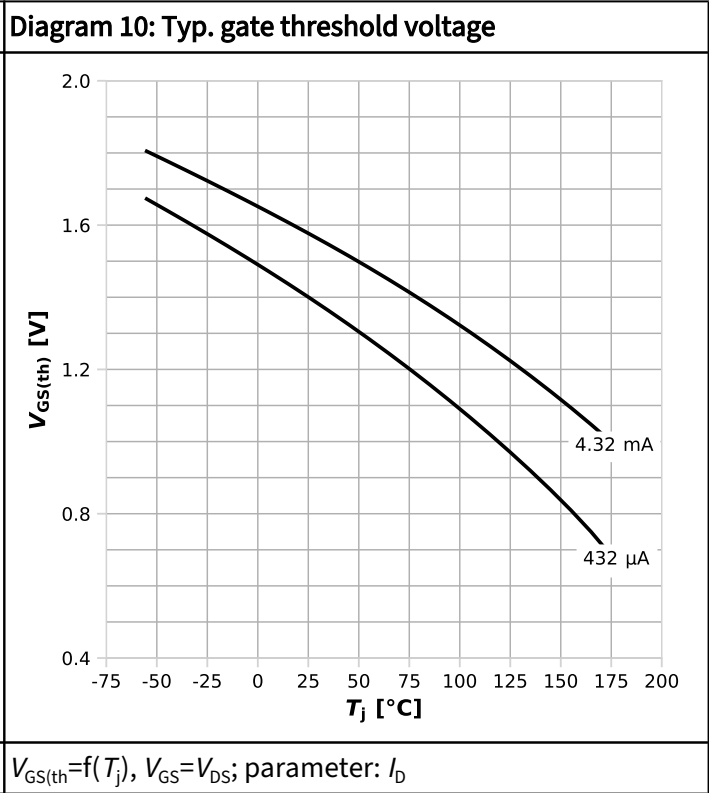
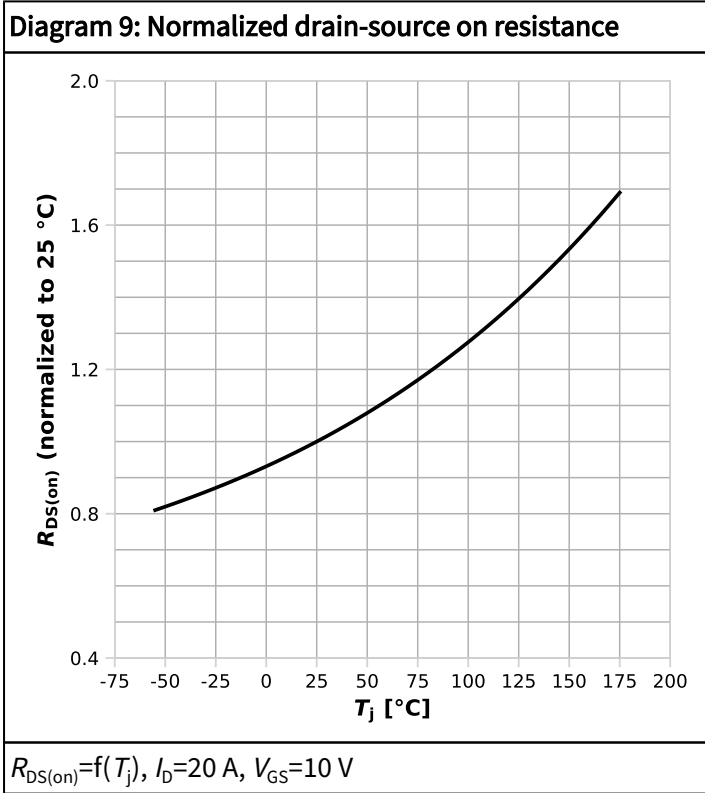
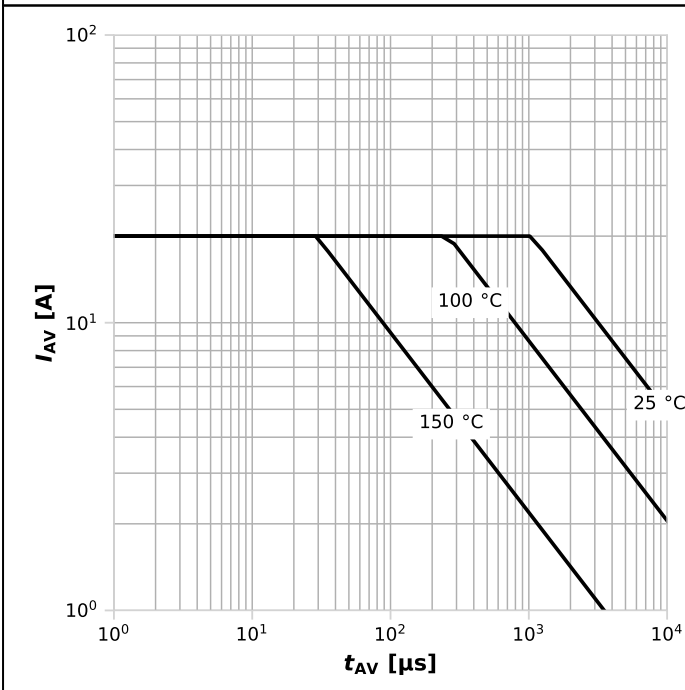
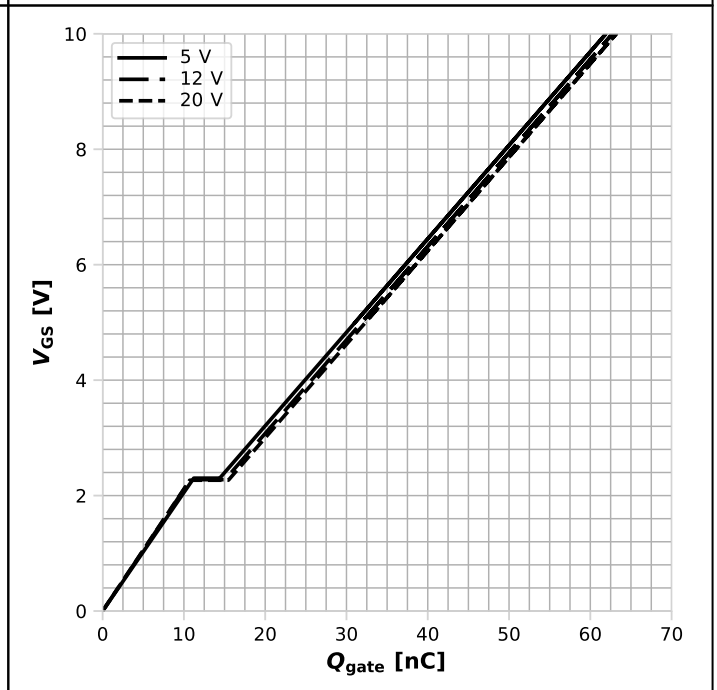

Diagram 13: Avalanche characteristics



$I_{AS}=f(t_{AV}); R_{GS}=25 \Omega$; parameter: $T_{j,start}$

Diagram 14: Typ. gate charge



$V_{GS}=f(Q_{gate}), I_D=20 \text{ A pulsed}, T_j=25 \text{ °C}$; parameter: V_{DD}

Diagram 15: Min. drain-source breakdown voltage

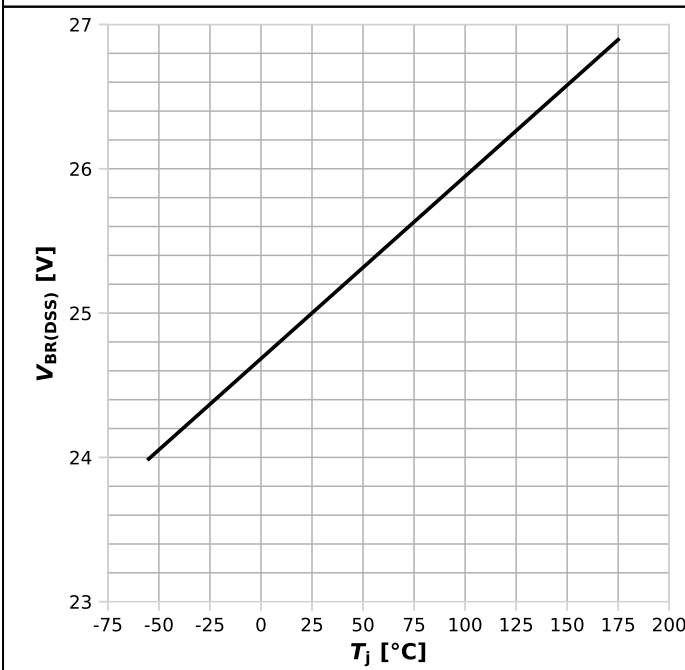

$V_{BR(DSS)}=f(T_j); I_D=1 \text{ mA}$

Gate charge waveforms

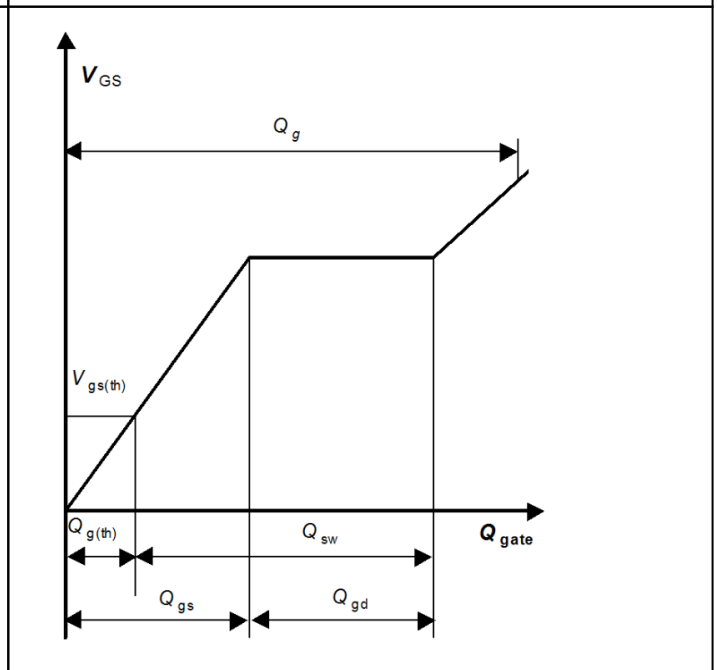

-

5 Package outlines

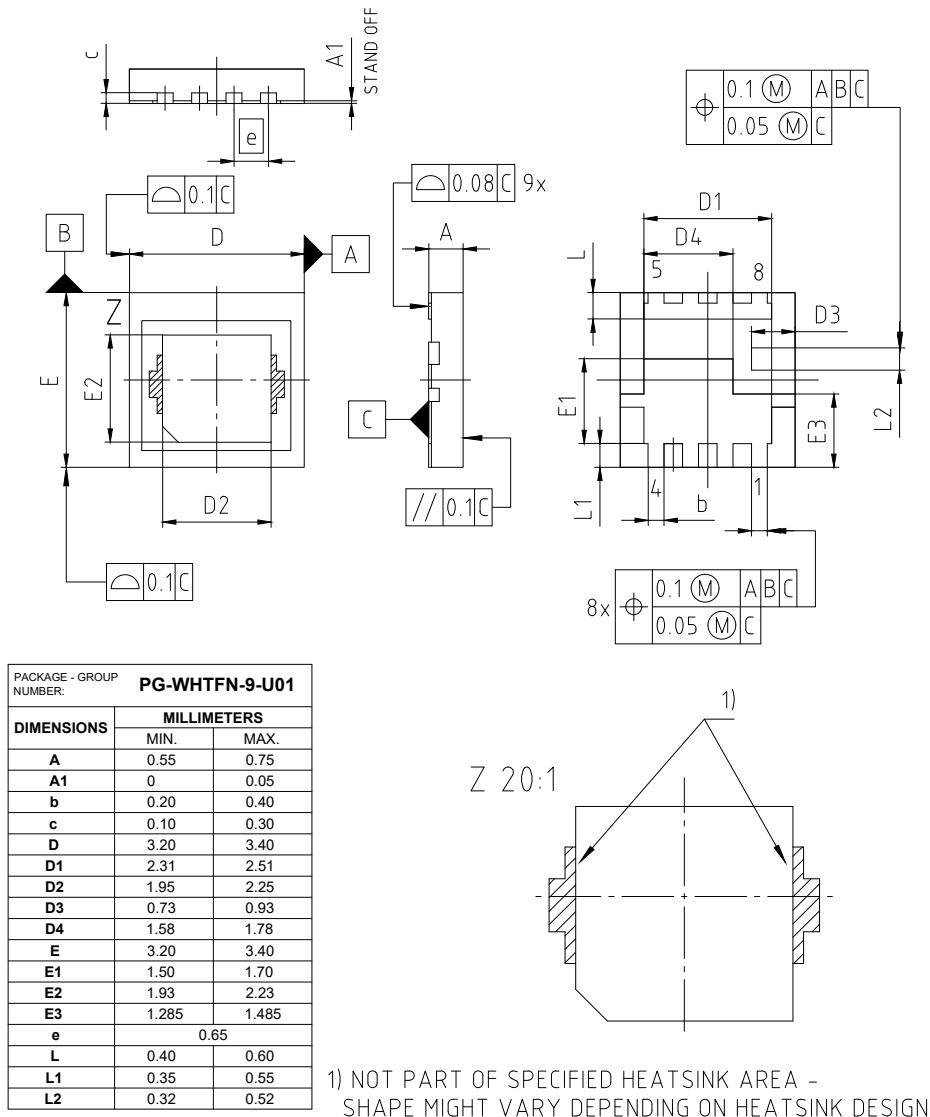

Figure 1 Outline PG-WHTFN-9, dimensions in mm

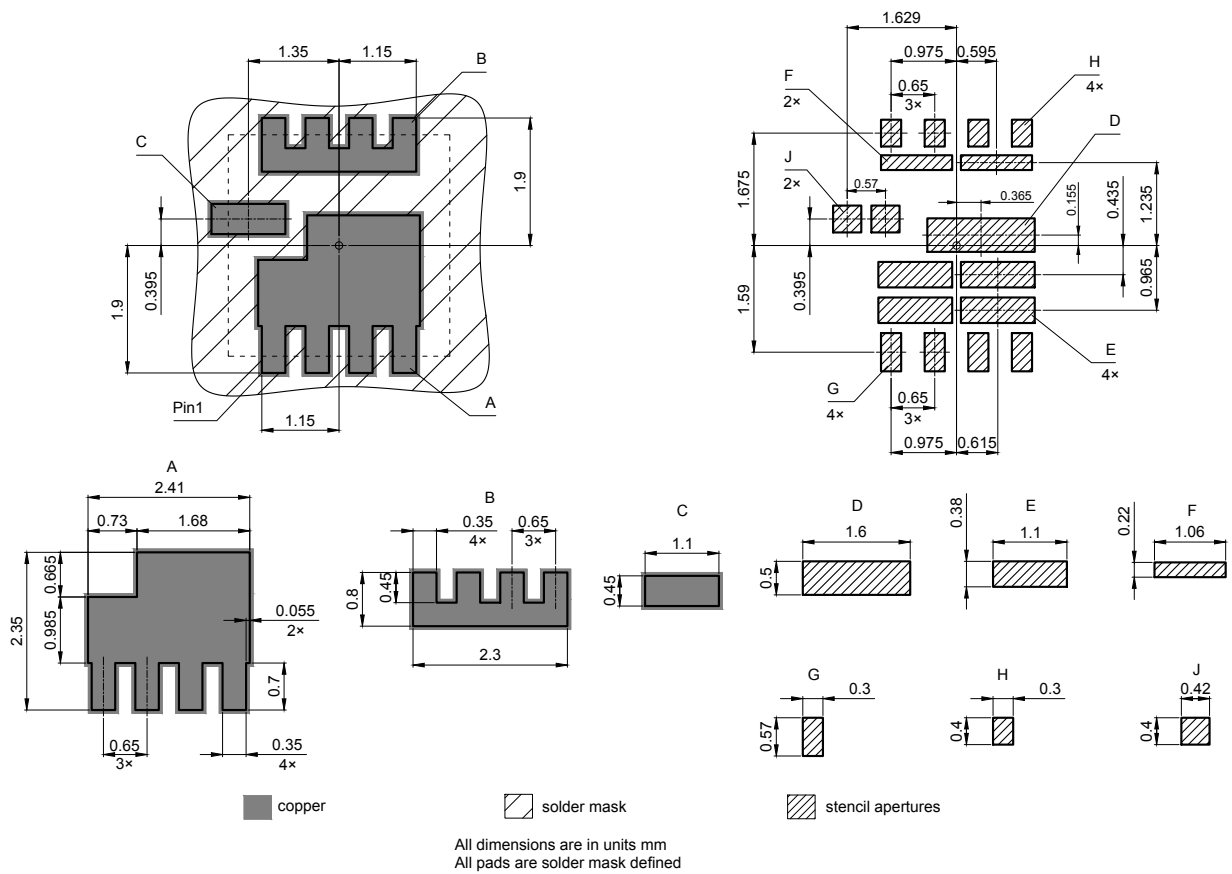
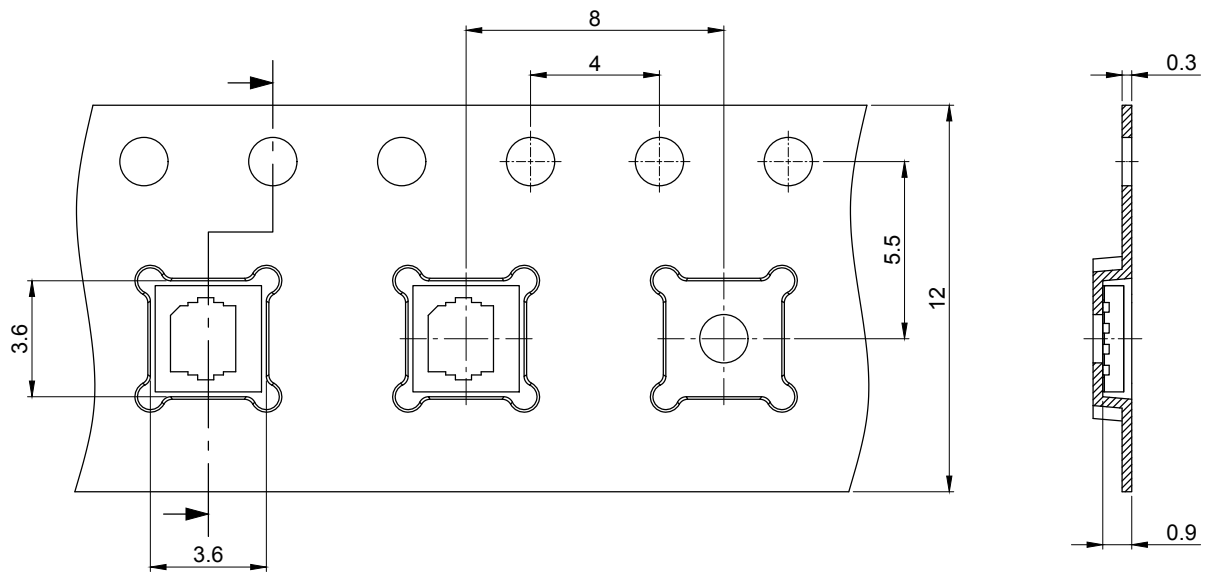

Figure 2 Footprint drawing PG-WHTFN-9, dimensions in mm



All dimensions are in units mm
The drawing is in compliance with ISO 128-30, Projection Method 1 [⊥]

Figure 3 Packaging variant PG-WHTFN-9, dimensions in mm



Revision history

IQEH42NE2LM7ZCGSC

Revision 2025-08-05, Rev. 1.0

Previous revisions

Revision	Date	Subjects (major changes since last revision)
1.0	2025-08-05	Release of final datasheet

Trademarks

All referenced product or service names and trademarks are the property of their respective owners.

We Listen to Your Comments Any information within this document that you feel is wrong, unclear or missing at all? Your feedback will help us to continuously improve the quality of this document. Please send your proposal (including a reference to this document) to: erratum@infineon.com

Published by

Infineon Technologies AG

81726 München, Germany

© 2025 Infineon Technologies AG

All Rights Reserved.

Important notice

The products which may also include samples and may be comprised of hardware or software or both ("Product") are sold or provided and delivered by Infineon Technologies AG and its affiliates ("Infineon") subject to the terms and conditions of the frame supply contract or other written agreement(s) executed by a customer and Infineon or, in the absence of the foregoing, the applicable Sales Conditions of Infineon. General terms and conditions of a customer or deviations from applicable Sales Conditions of Infineon shall only be binding for Infineon if and to the extent Infineon has given its express written consent.

For the avoidance of doubt, Infineon disclaims all warranties of non-infringement of third-party rights and implied warranties such as warranties of fitness for a specific use/purpose or merchantability.

Infineon shall not be responsible for any information with respect to samples, the application or customer's specific use of any Product or for any examples or typical values given in this document.

The data contained in this document is exclusively intended for technically qualified and skilled customer representatives. It is the responsibility of the customer to evaluate the suitability of the Product for the intended application and the customer's specific use and to verify all relevant technical data contained in this document in the intended application and the customer's specific use. The customer is responsible for properly designing, programming, and testing the functionality and safety of the intended application, as well as complying with any legal requirements related to its use.

Unless otherwise explicitly approved by Infineon, Products may not be used in any application where a failure of the Product or any consequences of the use thereof can reasonably be expected to result in personal injury. However, the foregoing shall not prevent the customer from using any Product in such fields of use that Infineon has explicitly designed and sold it for, provided that the overall responsibility for the application lies with the customer.

If the Product includes security features:

Because no computing device can be absolutely secure, and despite security measures implemented in the Product, Infineon does not guarantee that the Product will be free from intrusion, data theft or loss, or other breaches ("Security Breaches"), and Infineon shall have no liability arising out of any Security Breaches.

If this document includes or references software:

The software is owned by Infineon under the intellectual property laws and treaties of the United States, Germany, and other countries worldwide. All rights reserved. Therefore, you may use the software only as provided in the software license agreement accompanying the software. If no software license agreement applies, Infineon hereby grants you a personal, non-exclusive, non-transferable license (without the right to sublicense) under its intellectual property rights in the software (a) for software provided in source code form, to modify and reproduce the software solely for use with Infineon hardware products, only internally within your organization, and (b) to distribute the software in binary code form externally to end users, solely for use on Infineon hardware products. Any other use, reproduction, modification, translation, or compilation of the software is prohibited.

For further information on technology, delivery terms and conditions and prices please contact your nearest Infineon Technologies Office (www.infineon.com).